

 hachette  
PARTWORKS LTD

# U 96

---

# U-BOAT

---

Pack 8

Kits 29-32



**BUILD THE ICONIC WORLD WAR II U-BOAT**



# U 96

---

# U-BOAT

## Pack 8

### Assembly Instructions

Kit 29: Three more connectors

Kit 30: The hull

Kit 31: The first magnet

Kit 32: Hull section

 hachette  
PARTWORKS LTD

Hachette Partworks Ltd  
4th Floor, Jordan House,  
47 Brunswick Place, London, N1 6EB  
[www.U96-collection.com](http://www.U96-collection.com)

© 2023/2024 Hachette Partworks Ltd.  
ALL RIGHTS RESERVED  
Not suitable for children under 14.

**WARNING:** All parts belong to a kit.  
Collectors' item for adults. Not suitable for  
children under 14. Some parts may have  
sharp edges, please handle them with care.

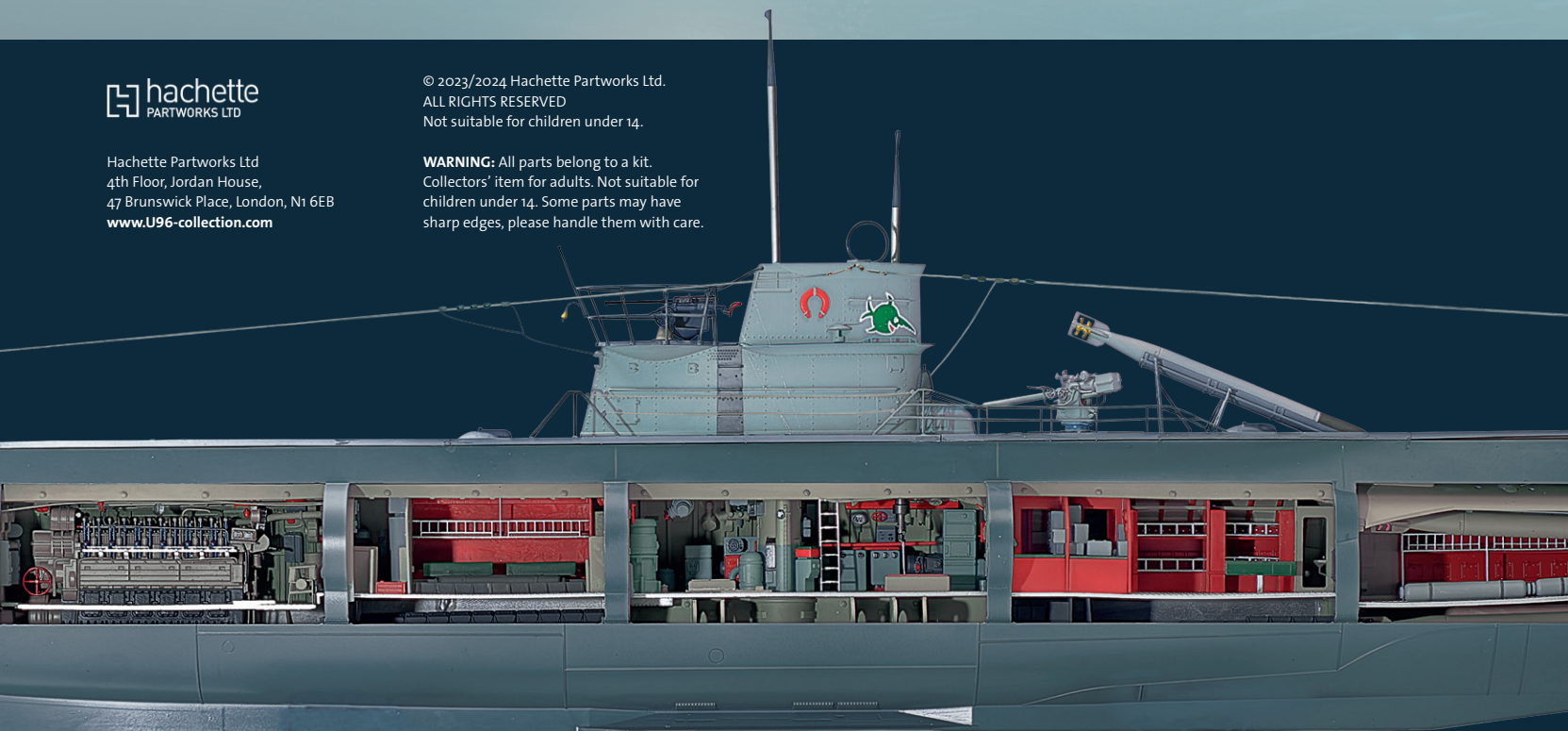

# Kit 29: Three more connectors

After adding a marker label to a cable, you will connect it to the forward circuit board. Then, three connecting pieces are added to the hull structure and bow compartment bulkhead.



Parts reference list	
Part no.	Name
29-1	Hull connector
29-2	Hull connector
29-3	Hull connector
29-4	Cable
29-5	Cable label

Screws		
Ref	No.	Dimensions
AM	4+1	2 x 4 mm
DM	2+1	2 x 6 mm
DP	2+1	2 x 6 mm



## Kit 29: Three more connectors

### STAGE 1 → Connecting the cable

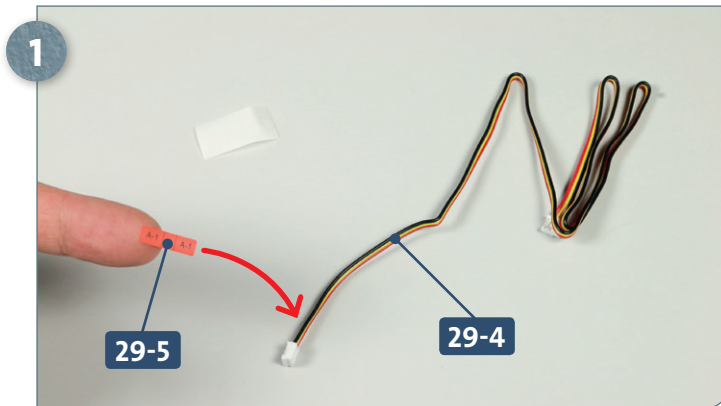

Peel the cable label **29-5** from the backing film and wrap it around the cable **29-4** approximately 8mm from a connector. As both ends are the same, it doesn't matter to which end the label is attached.

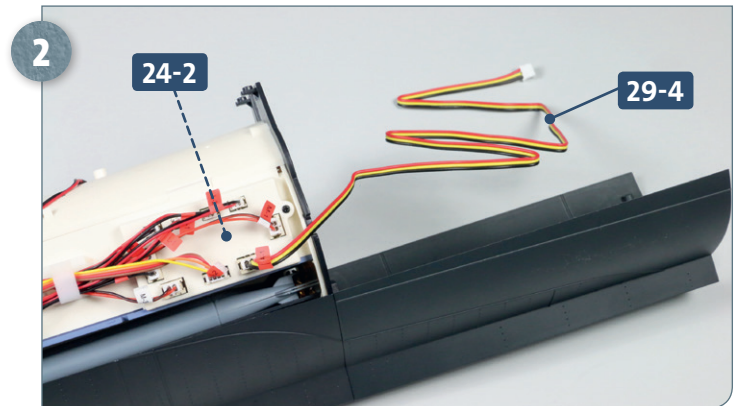

Insert one of the ends of the cable **29-4** into port 6 of the PCB **24-2**. Contrary to what is pictured, insert the end of the cable furthest from the label.

### STAGE 2 → Attaching the connectors

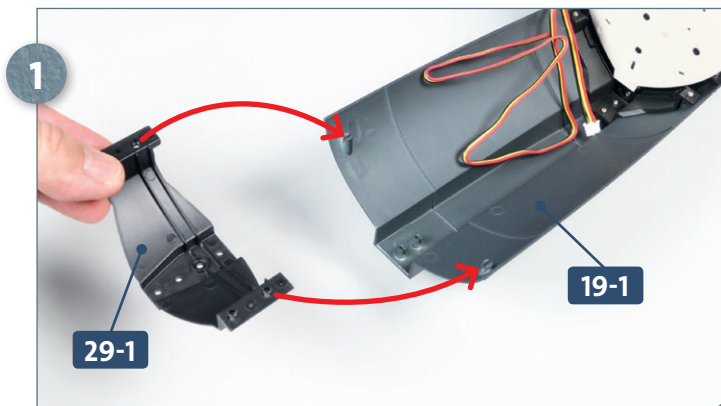

Holding the connector piece **29-1** as shown above, fit it onto the back of the lower hull section **19-1**, as indicated by the arrows.

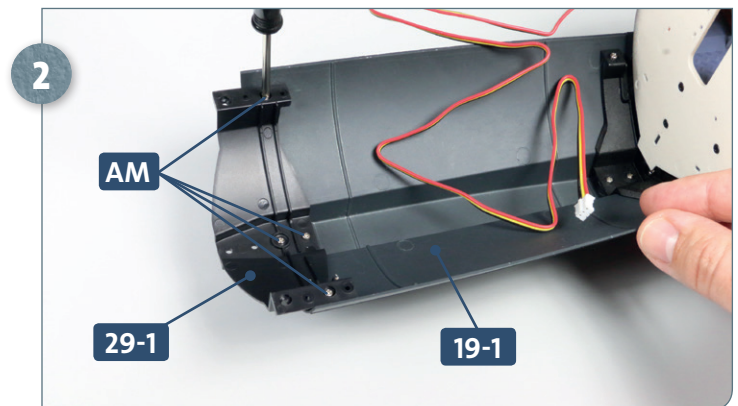

Fix the connector **29-1** in place using four **AM** screws.

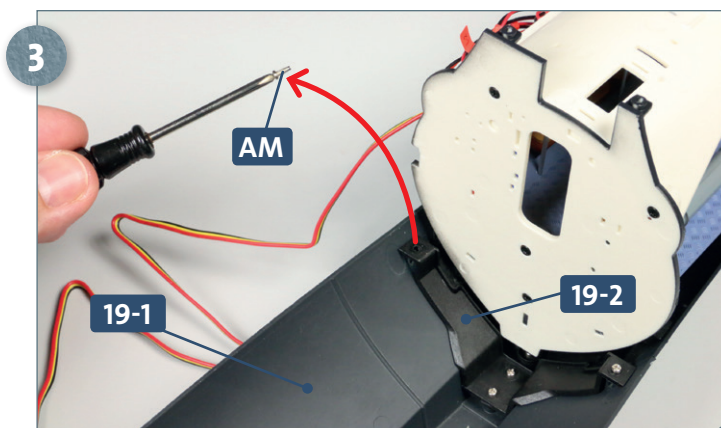

Now working at the forward end of the section **19-1**, remove the **AM** screw from connector **19-2**, as shown. The **AM** screw is no longer needed, so keep it aside as a spare.

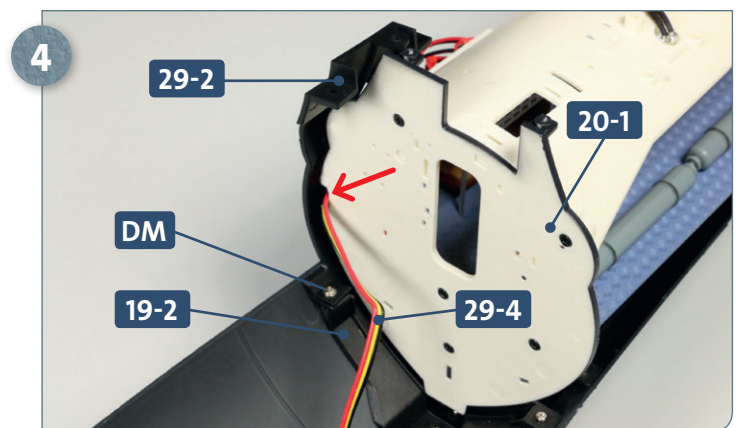

Fit connector **29-2** onto connector **19-2** and attach the two pieces together using a **DM** screw. The cable **29-4** should be routed through the recess between the connector **29-2** and the bow compartment bulkhead **20-1**.



## Kit 29: Three more connectors

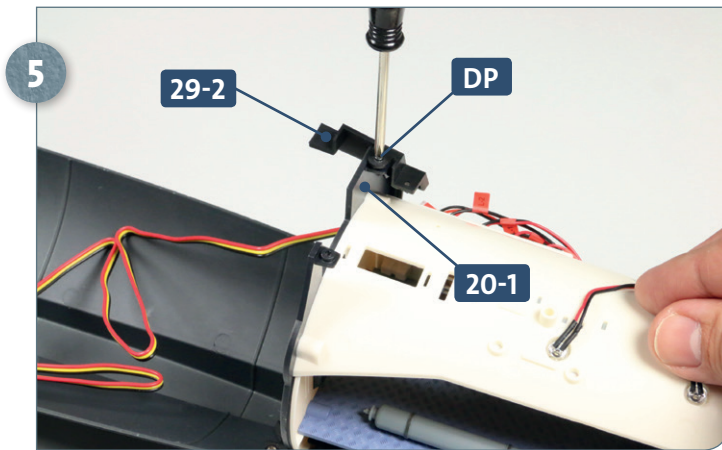

Connect the upper part of the connector **29-2** to the bow compartment bulkhead **20-1** using a **DP** screw, as shown.

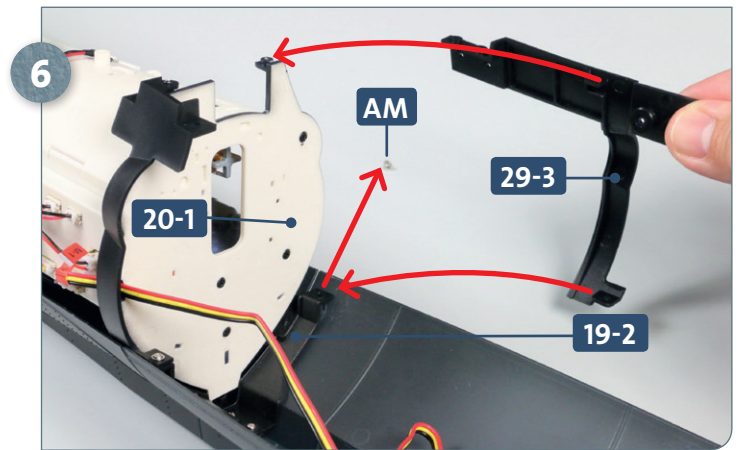

Now working from the other side of the hull, remove the **AM** screw from connector **19-2** and keep it aside as a spare. Fit connector **29-3** onto connector **19-2** and the bow compartment bulkhead **20-1**, as indicated by the curved arrows.

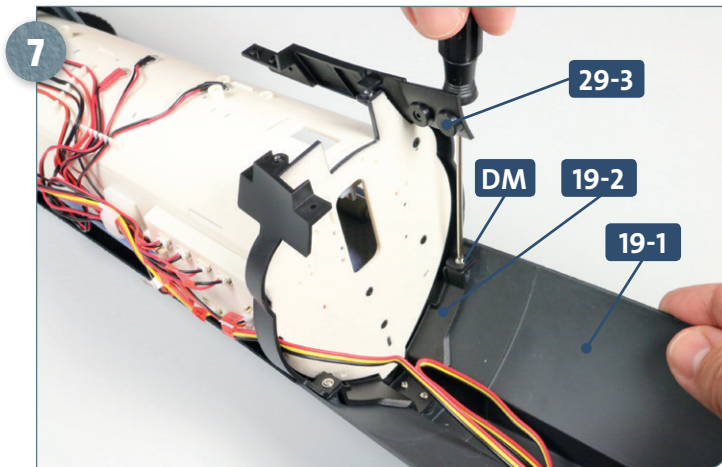

Fix the connection piece **29-3** to the other connector **19-2** (and to the lower part of the hull, **19-1**) using a **DM** screw, as shown.

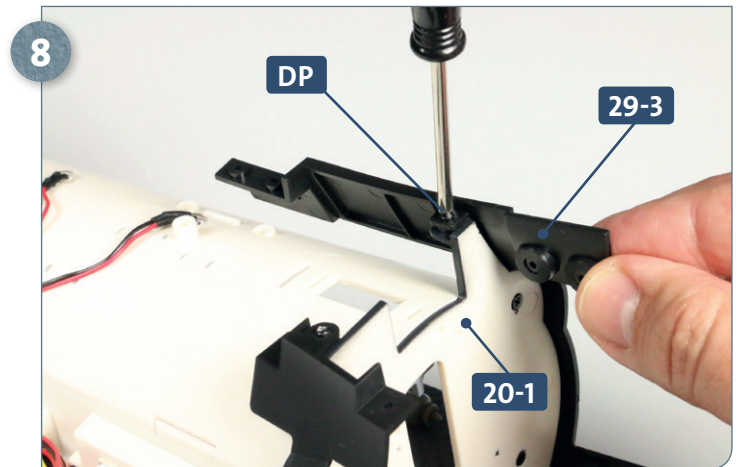

Finally, attach the other end of the connector **29-3** to the bow compartment bulkhead **20-1** using a **DP** screw.

## COMPLETED WORK

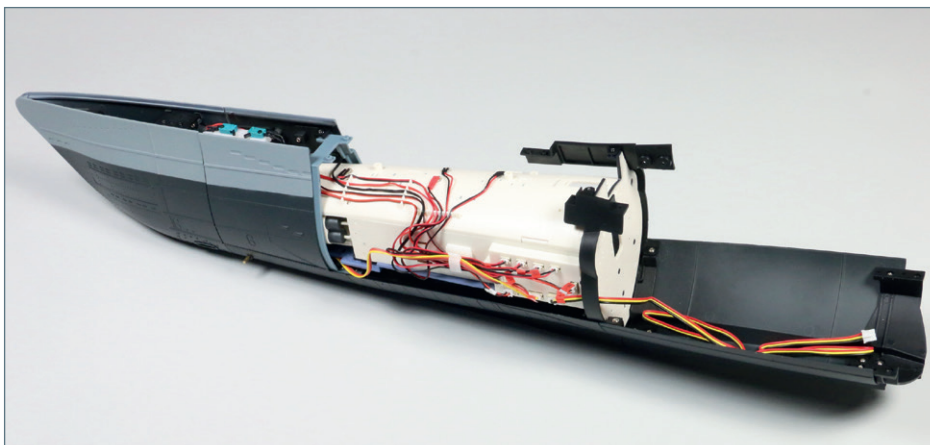

A cable has been labelled and connected to the circuit board, and three connecting pieces have been attached to the hull structure and the bow compartment bulkhead.



# Kit 30: The hull

The next lower hull section is added to the assembly. Two pieces of cardboard are then folded to make a stand for the structure.

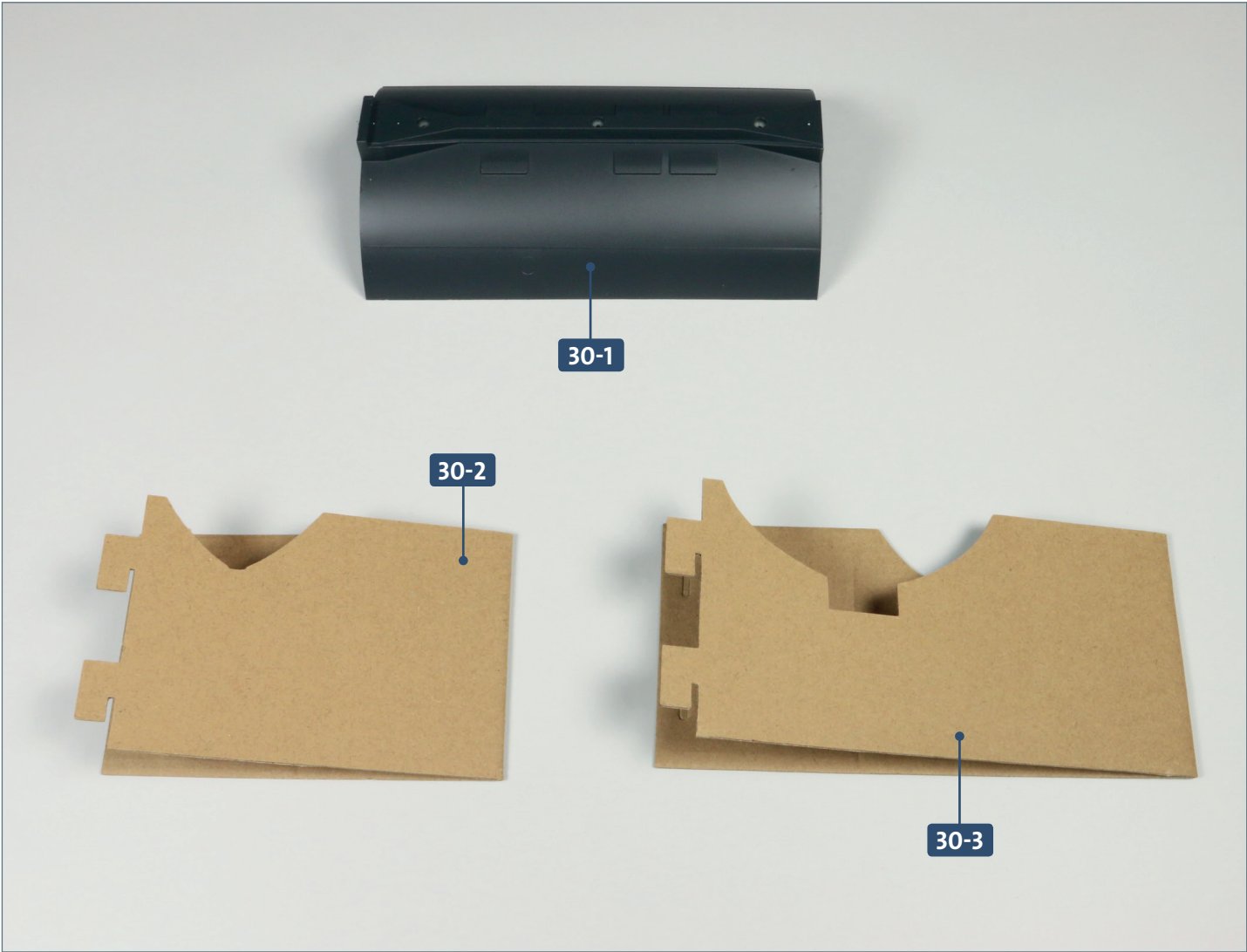

Parts reference list	
Part no.	Name
30-1	Lower hull section
30-2	Stand
30-3	Stand

Screws		
Ref	No.	Dimensions
AM	4+1	2 x 4 mm



**STAGE 1** → Attaching the hull section

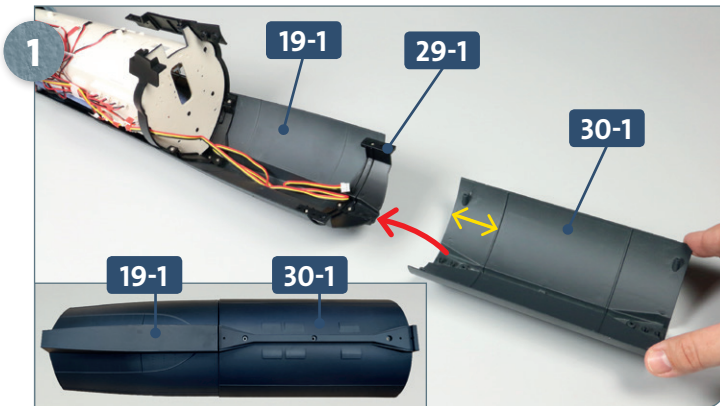

Take the lower hull section 30-1 and lay it on your work surface. Note that the gap between the end and the transverse rib is smaller at the forward end (yellow arrow). See also the inset photo showing the hull from below. Fit the section 30-1 to the connector 29-1, which is located at the aft end of section 19-1.

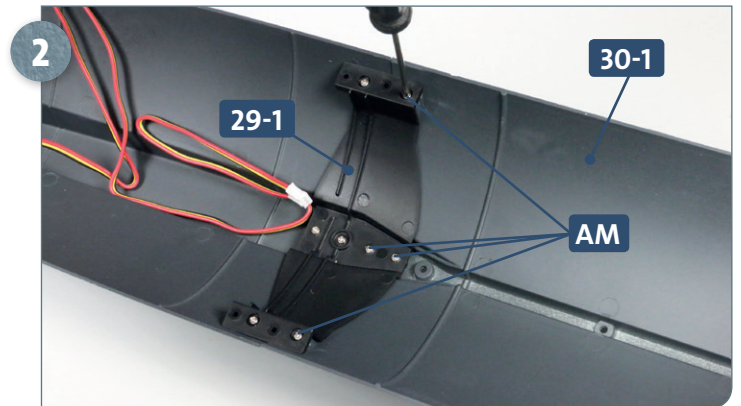

Attach the hull section 30-1 to the connector 29-1 using four AM screws through the free holes, as shown above.

**STAGE 2** → Folding the temporary stand

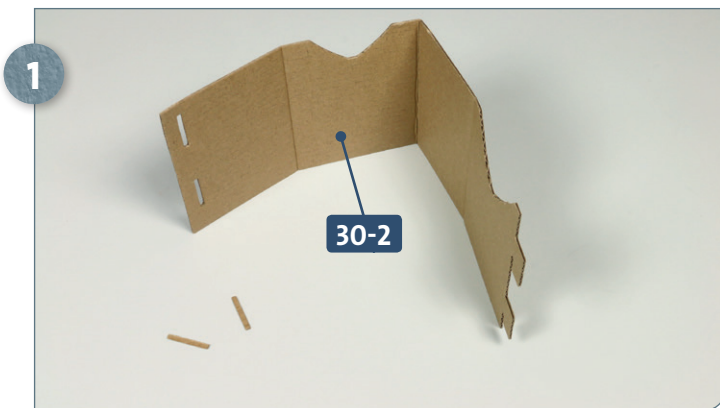

Take the first part of the stand 30-2 and, if necessary, remove the two small rectangular pieces from the perforated slots.

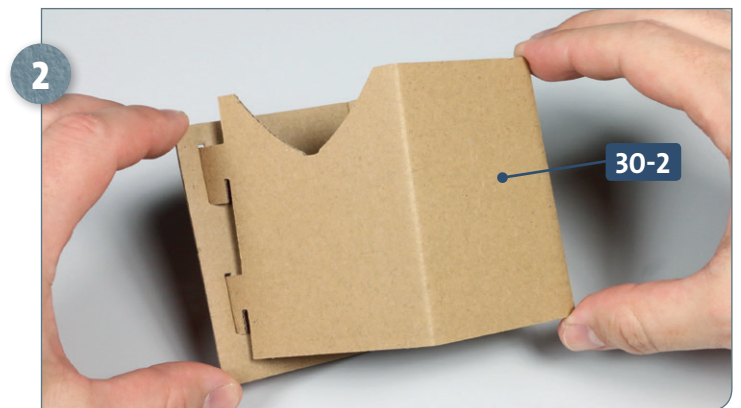

Fold the stand 30-2 along the two folds to form a rectangular tube. The two tabs at the end are inserted into the two slots, as shown.

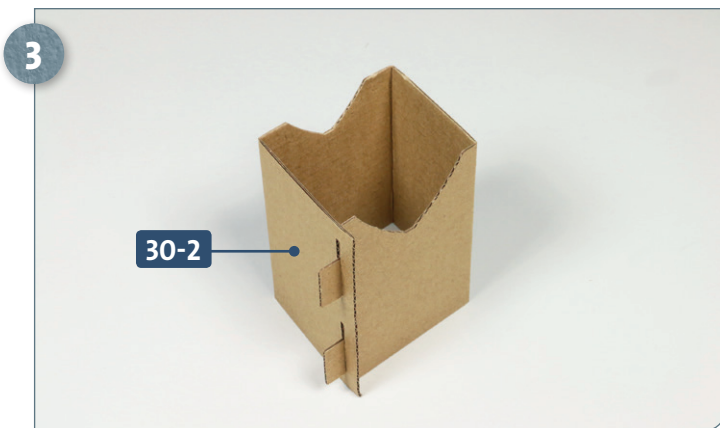

Gently press down on the two tabs of the stand 30-2 until they are firmly resting in the slots. Adjust the stand so that the opposite sides are parallel.

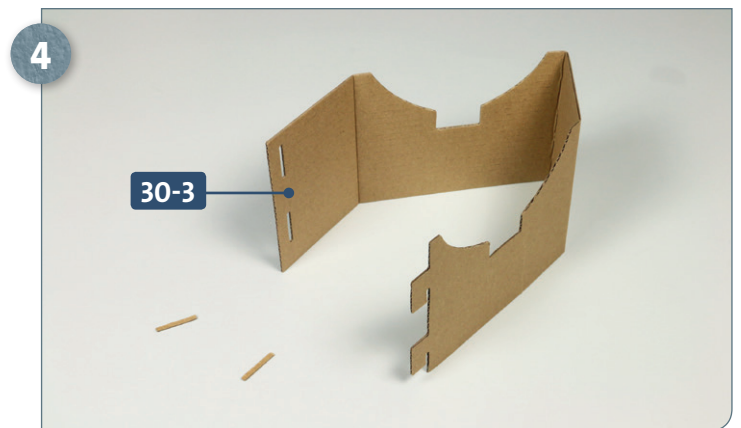

Now repeat the process with the second stand 30-3. First, remove the two small rectangular pieces, as shown.



## Kit 30: The hull

5

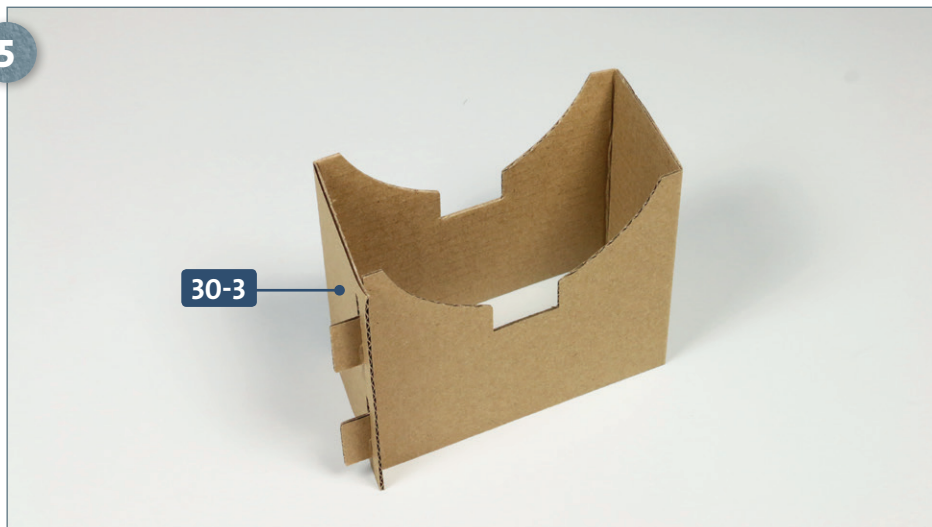

Fold the stand 30-3 along both folds, creating a rectangular tube. Insert the two tabs into the slots and press down gently to seat them.

6

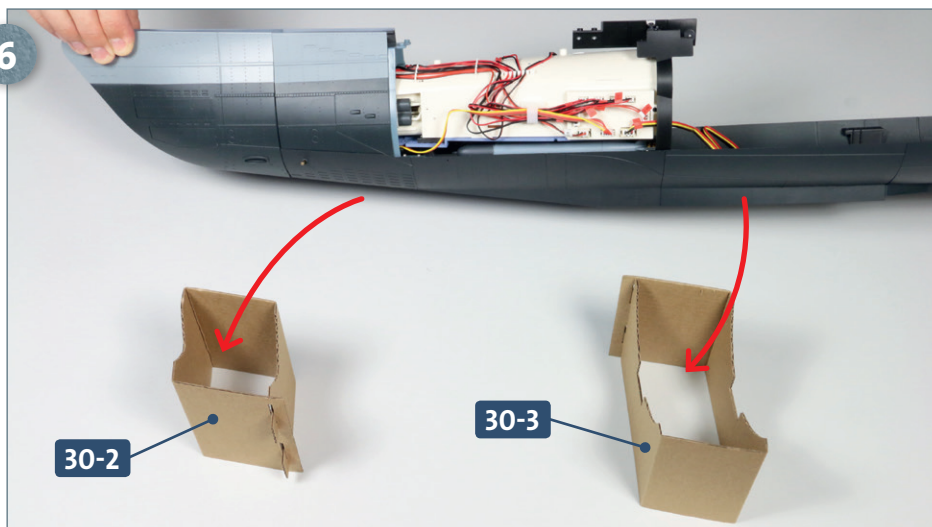

Line up the two stands 30-2 and 30-3 as shown in the photo. Take the hull assembly and rest it across the stands, as indicated by the arrows.

## COMPLETED WORK

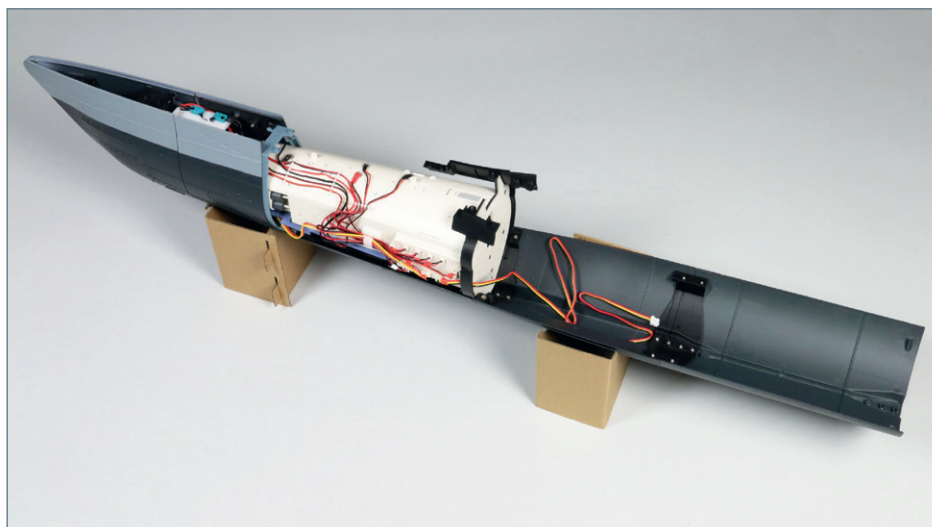

The hull has grown by another section and now rests on two temporary cardboard stands.



# Kit 31: The first magnet

Upper deck parts and a compressed air cylinder are first assembled and then glued to the assembly above the bow compartment. The front bracket is attached to the model, and the first magnet inserted into the bracket.

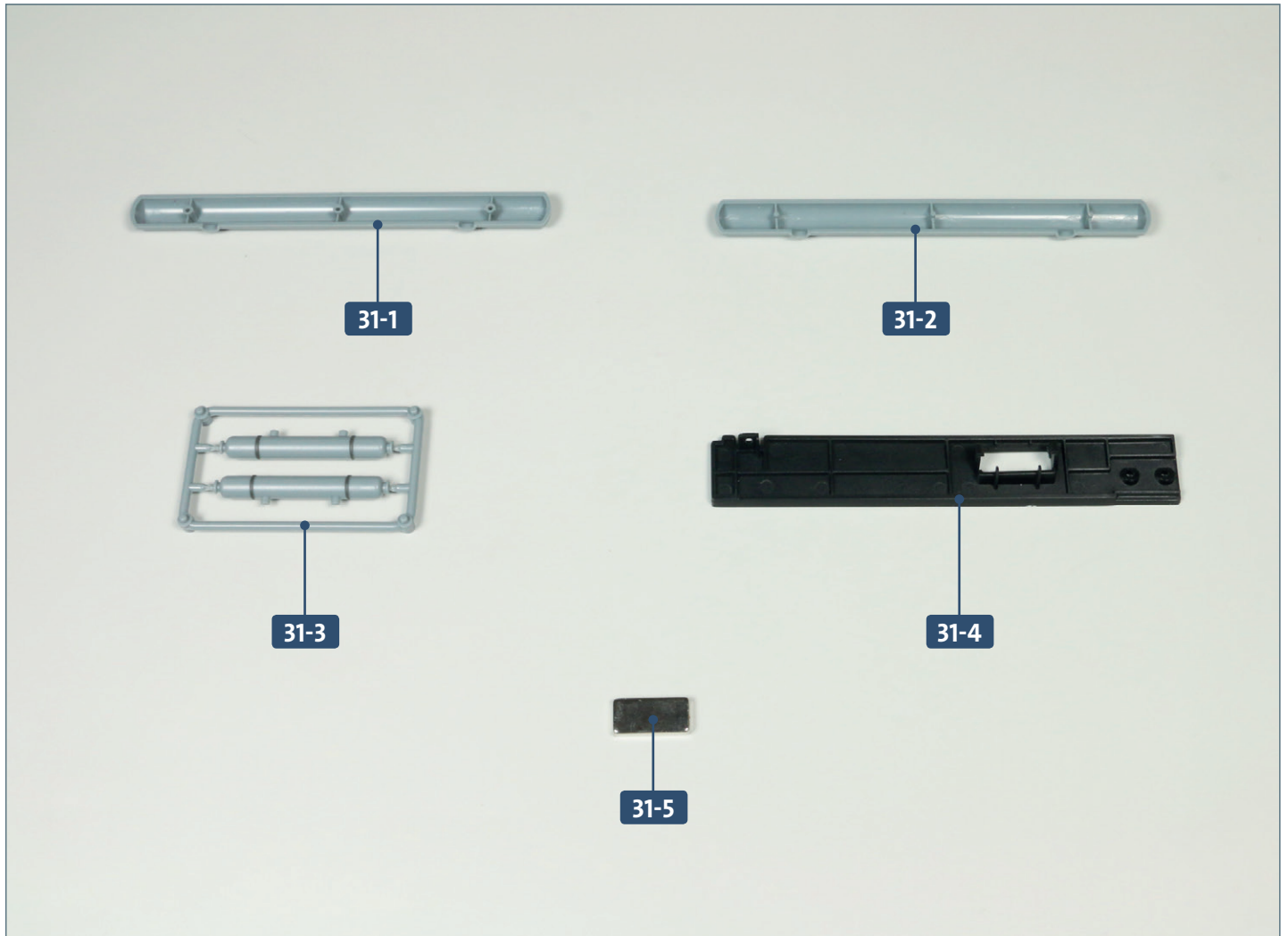

Parts reference list	
Part no.	Name
31-1	Upper deck compartment
31-2	Upper deck compartment
31-3	Compressed air cylinder
31-4	Front bracket
31-5	Magnet

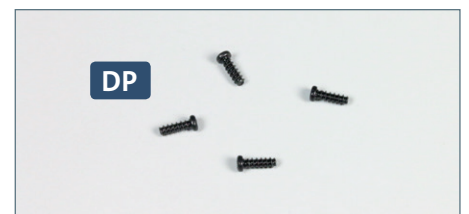

Screws		
Ref	No.	Dimension
DP	3+1	2 x 6 mm

## Kit 31: The first magnet

### STAGE 1 → Assembling the upper deck pieces and compressed air bottle

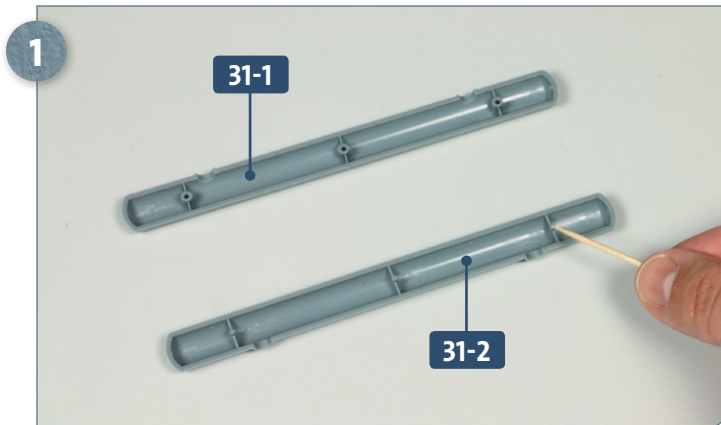

Place both halves of the upper deck compartment 31-1 and 31-2 on your work surface. Apply some glue to the pegs of 31-2, as shown in the photo.

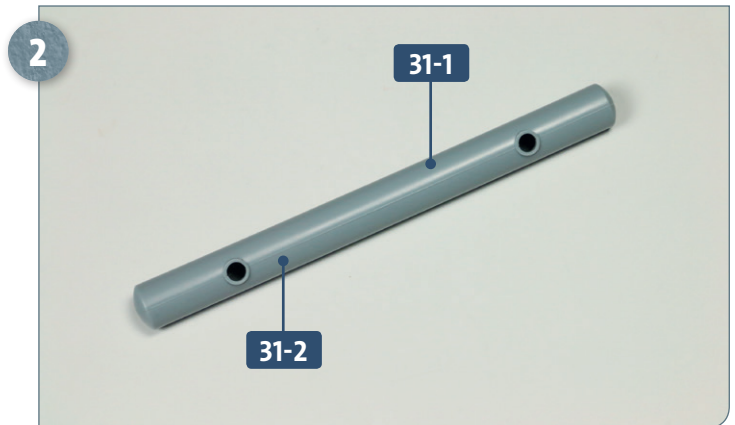

Glue the two halves 31-1 and 31-2 together, ensuring that they fit snugly with no gaps.



Remove both halves of the compressed air cylinder from the frame 31-3, as shown. Using a fine file or sandpaper, remove any rough edges remaining after removing from the frame.

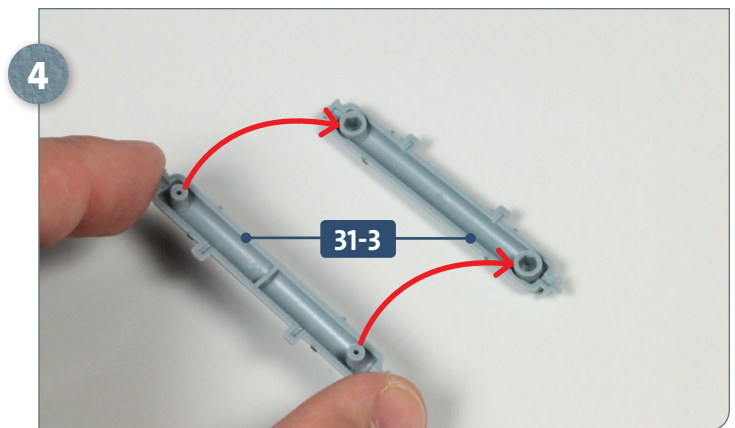

Apply some glue to the contact points of the two halves of the compressed air cylinder 31-3 and fit them together as indicated by the arrows.

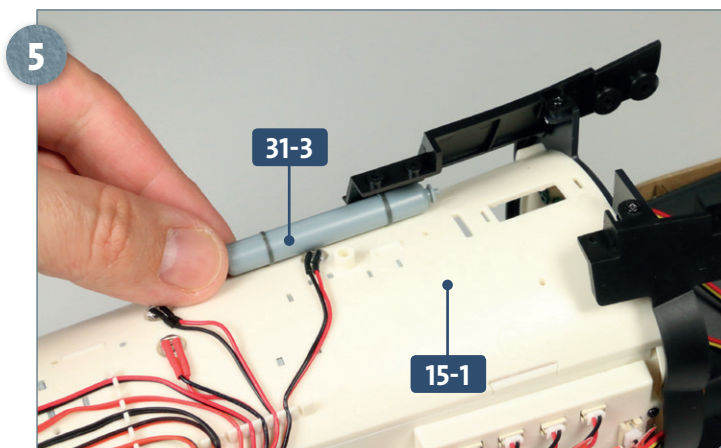

After placing your model on the work surface, study the photo carefully. Note the orientation of the compressed air cylinder. Apply some glue to the two pegs of the compressed air cylinder 31-3 and fit these into the two holes in the deckhead of the bow compartment 15-1.

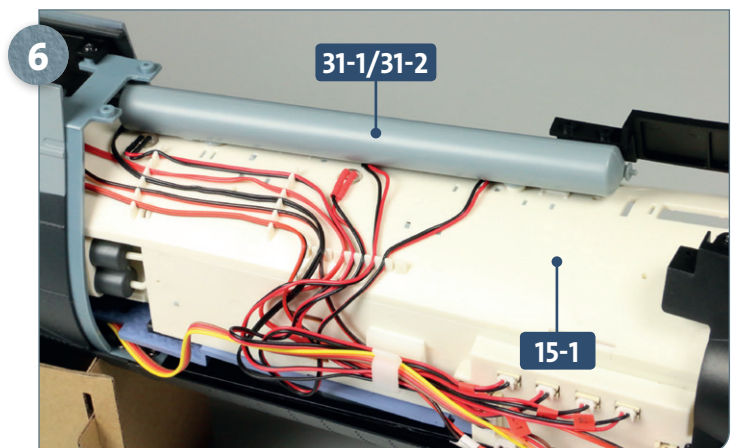

Next, apply some glue to the two raised sockets of the bow compartment deckhead 15-1 and fit the holes in the upper deck compartment assembly 31-1/31-2 onto these, as shown above.



### STAGE 2 → Installing the front bracket and magnet

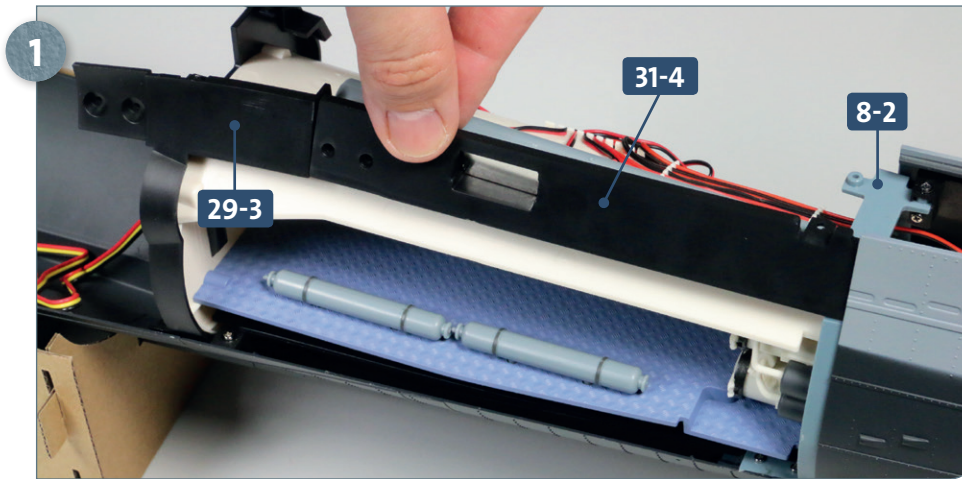

From above, slide the magnet 31-5 into the holding slot in the bracket 31-4 (see inset picture). Then fit the bracket between the two connectors 29-3 and 8-2 on the starboard (R) side of the hull.

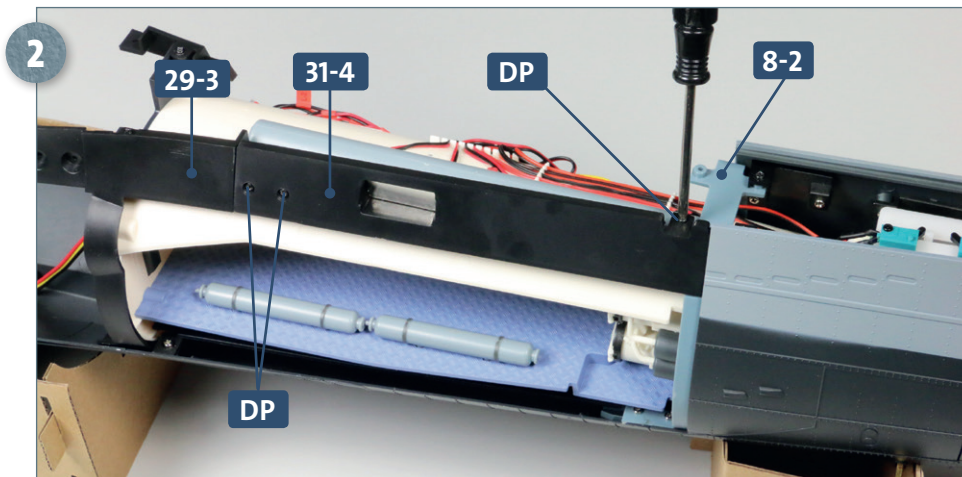
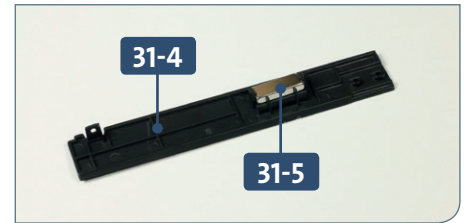

Fix the front bracket 31-4 in place using one DP screw into connector 8-2 and two DP screws into connector 29-3, as shown.

### COMPLETED WORK



The upper deck compartment and a compressed air cylinder have now been mounted on the deckhead of the bow compartment. A magnet has been fitted into a bracket, which has been attached to the model.

# Kit 32: Hull section

A new upper section of the hull is fitted with two connectors and then added to the assembly. A beam is then secured to the hull structure.



Parts reference list	
Part no.	Name
32-1	Upper hull section
32-2	Connector
32-3	Connector
32-4	Beam

Screws		
Ref	No.	Dimension
AM	4+1	2 x 4 mm
DP	6+1	2 x 6 mm



**STAGE 1** → Installing the hull section and beam

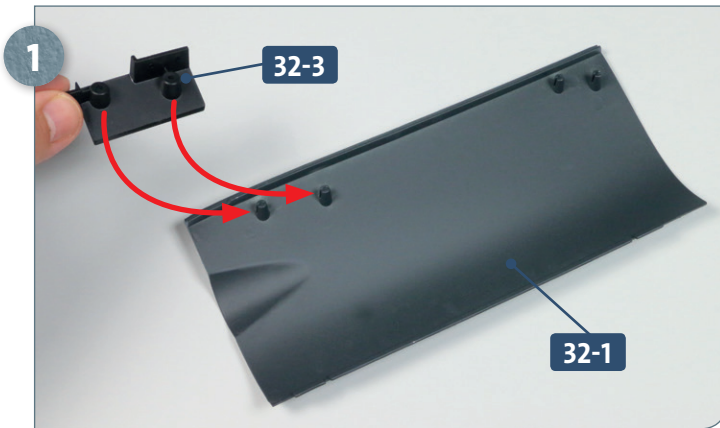

Place the hull section 32-1 on your work surface, the interior side facing up. Take the connector 32-3 and fit it onto the rear raised screw sockets of the hull section as shown.

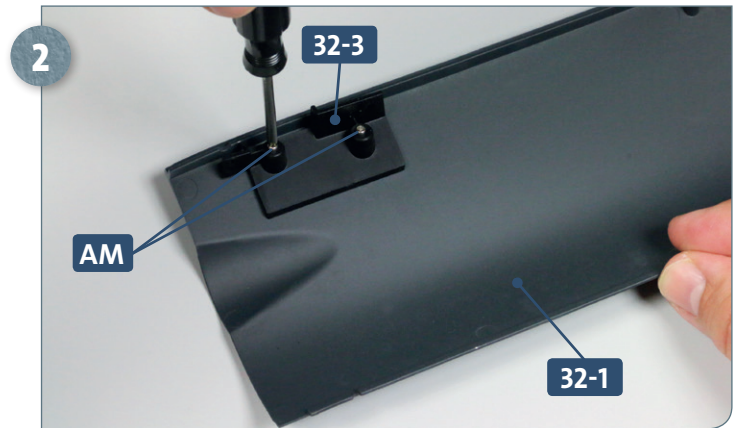

Fix the connector 32-3 to the hull piece 32-1 using two AM screws.

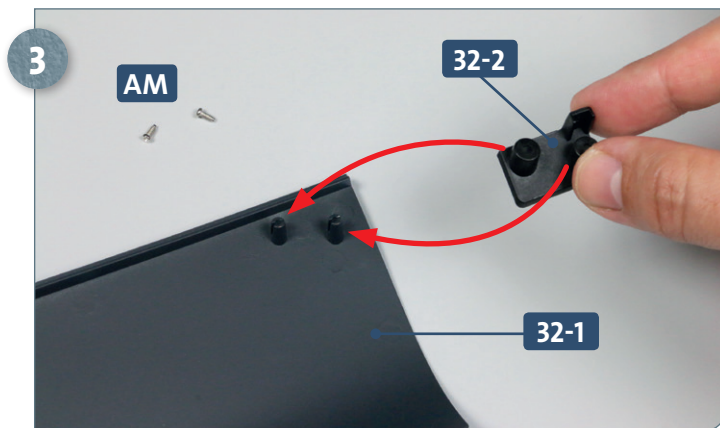

Fit connector 32-2 onto the raised screw sockets at the other end of the hull section 32-1. Have two AM screws ready.

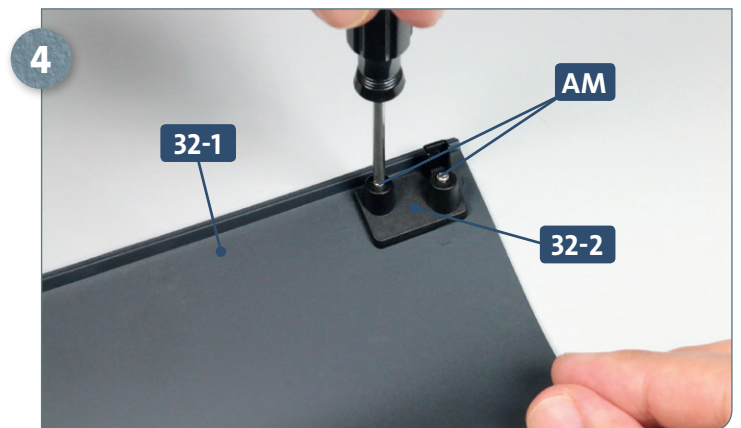

Secure the connector 32-2 in place using the two AM screws.

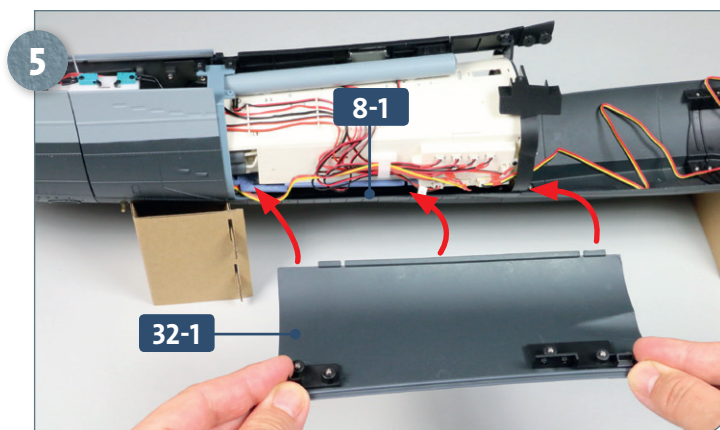

Fit the hull section 32-1 onto the port (L) side of the hull structure. The lower edge fits into hull section 8-1, as indicated by the arrows.

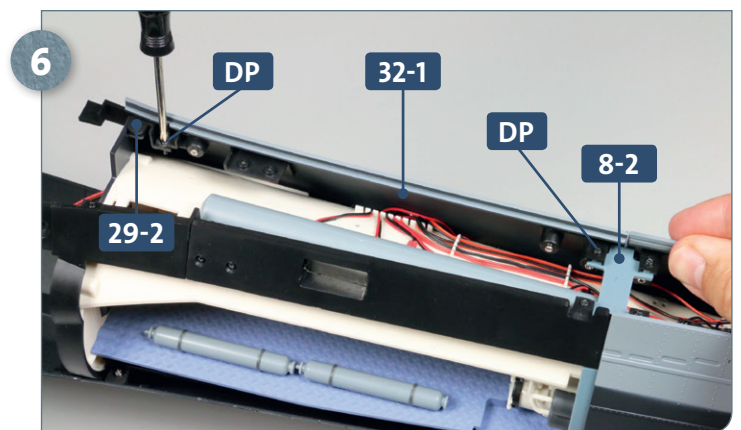

Viewed from the other side: fix the hull section 32-1 in place using one DP screw into each connector, 8-2 and 29-2.

## Kit 32: Hull section

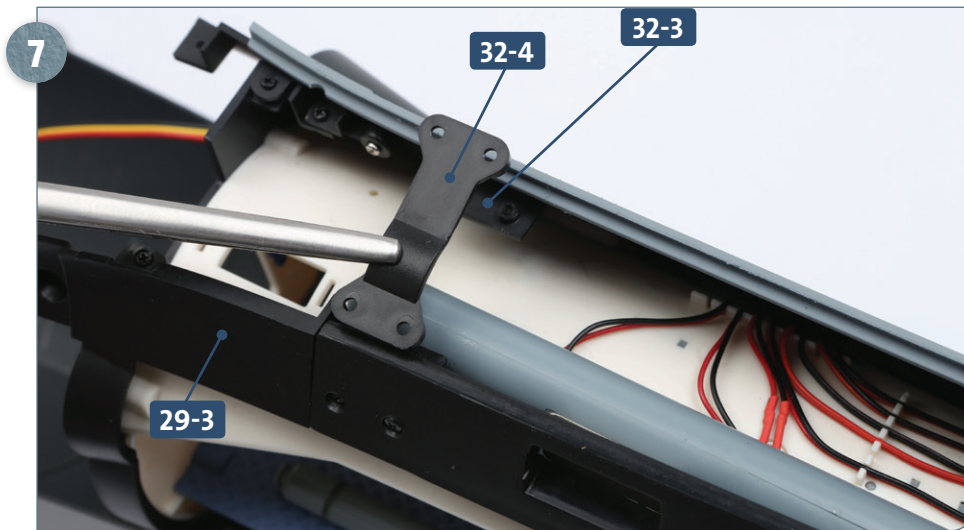

Take the beam 32-4 and fit it between the two connectors 32-3 and 29-3, as shown.

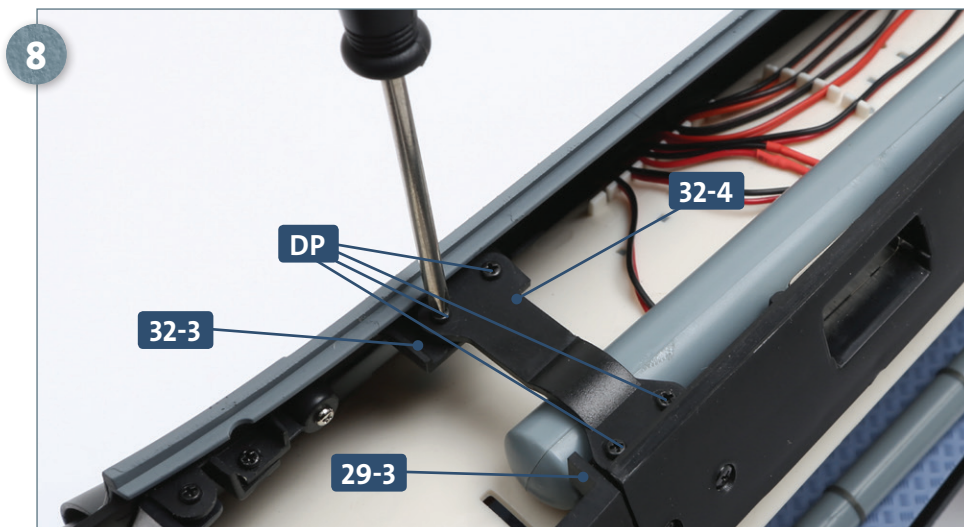

Fix the beam 32-4 in place using two DP screws into connector 32-3 and another two into connector 29-3.

## COMPLETED WORK



A new hull section has been added to the upper part of the port (L) side of the structure, as well as a crossbeam.